

Code: 79C4X40

Hartland CFX | HARTLAND CFX RANGE | Resistive Leading Edge Push On/Off Rotary 2 Way Switching Dimmers

Product Image

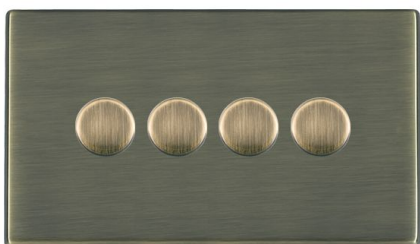

Wiring

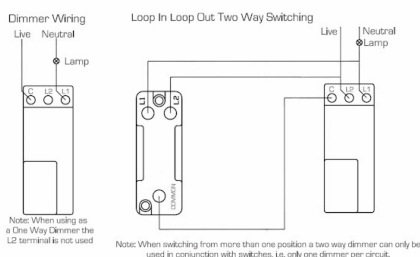

Insert Type

4 gang 400W Resistive Leading Edge Push On/Off Rotary 2 Way Switching Dimmer max 300W per gang

Insert Colour

Antique Brass

EAN13 Barcode

5017504299446

Commodity Code

85365015

Luckins TSI

388241714

ETIM Class

EC000025

Dimensions(Nominal)

Double: Height = 86.0mm Width = 145.0mm Depth = 5.0mm

Weight

325 GR

Fixing Hole Centres

Box Fixing = 120.6mm Grid Fixing = CFX Clips

Minimum Wall Box Depth

35mm

Current Rating

1.25 Amps per gang

Patents And Trade Marks

CFX is a Registered Trade Mark No 2398667 Hartland CFX is a Registered Design under Reference Nos. R21 = 3023446 SS2 = 3023445

Dimensions

Hamilton®
HARTLAND CFX

4X40

**Resistive Leading Edge Push On-Off Rotary
2 Way Switching Dimmer**

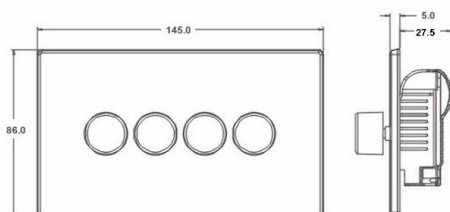

R Hamilton & Co Ltd, Unit 10 Carrick Business Centre,
4-5 Bonville Road, Brislington, Bristol, BS4 5NZ

T: +44 (0)1747 860088

E: info@hamilton-litestat.com | **W:** www.hamilton-litestat.com

(WEB)

All accessories are manufactured under an accredited BS EN ISO 9001:2015 Quality Management System. It is the policy of the company to improve products as part of our development programme. Therefore, we reserve the right to alter designs and dimensions without prior notice. Illustrations and diagrams are reproduced within the limitations of reproduction and printing process and are not binding. Due to manufacturing processes we cannot guarantee an exact colour match and shadings of certain finishes. This datasheet was generated on 19/05/2024 E&OE