

Code: 89D6126B

Sheer Floor Sockets | SHEER FLOOR SOCKETS RANGE | International Power Sockets

Product Image



Wiring

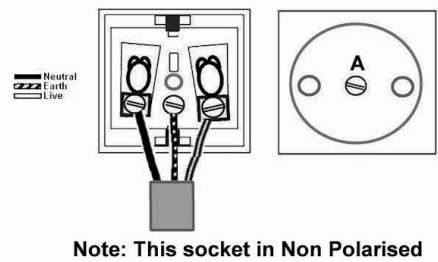

Dimensions

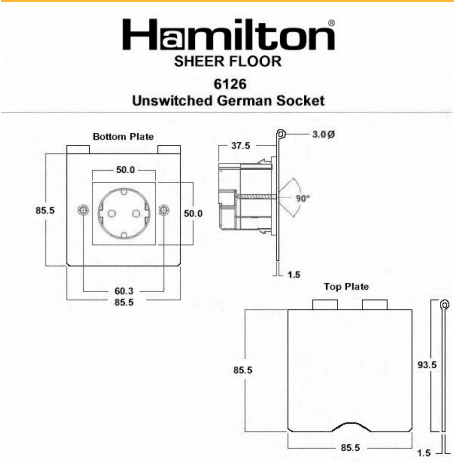

Insert Type	1 gang 10/16A 220/250V AC German Unswitched Socket
Insert Colour	Black
EAN13 Barcode	5017504035211
Commodity Code	85363010
Luckins TSI	398360067
ETIM Class	EC000125
Dimensions(Nominal)	Single: Height = 93.5mm Width = 85.5mm Depth = 3.0mm (6.5mm Hinged Cover)
Fixing Hole Centres	Box Fixing = 60.3mm Grid Fixing = N/A
Minimum Wall Box Depth	47mm
Switched Poles	None
Current Rating	10/16 Amp
Voltage	220/250V AC
Maximum Load	16 Amp
Mains Frequency	50Hz
IP Rating	IP2XD
Contact Gap Minimum	None
Terminal Capacity 1	3x2.5mm ²
Terminal Capacity 2	3x4mm ²
Terminal Capacity 3	2x6mm ² Multi-strand
Terminal Capacity 4	1x10mm ²
Product Class 1	Face plate must be earthed
Ambient Operating Temperature	-5° to +40°C
Recommended Location	Internal Use Only
Maximum Installation Altitude	2000m
Standard/Approval	BS EN ISO 5733 + IEC 60884-1
Additional Notes	Shuttered:Yes