

# DATASHEET

**Code:** LRX1X40BC-PB

## Linea-Rondo CFX | LINEA-RONDO CFX RANGE | Resistive Leading Edge Push On/Off Rotary 2 Way Switching Dimmers

### Product Image



### Wiring

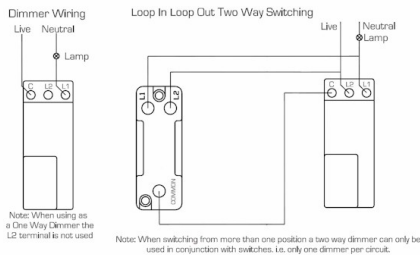

### Dimensions

**Hamilton**<sup>®</sup>  
LINEA RONDO CFX  
1X40

Resistive Leading Edge Push On-Off Rotary  
2 Way Switching Dimmer

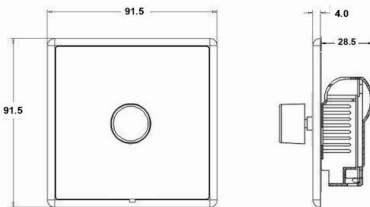

### Insert Type

1 gang 400W Resistive Leading Edge Push On/Off Rotary 2 Way Switching Dimmer

### Insert Colour

Bright Chrome

### EAN13 Barcode

5017504499419

### Commodity Code

85365015

### Luckins TSI

391671821

### ETIM Class

EC000025

### Dimensions(Nominal)

Single: Height = 91.5mm Width = 91.5mm Depth = 4.0mm

### Fixing Hole Centres

Box Fixing = 60.3mm Grid Fixing = CFX Clips

### Minimum Wall Box Depth

35mm

### Current Rating

1.66 Amp

### Patents And Trade Marks

Linea is a Registered Trade Mark No 2398665 CFX is a Registered Trade Mark No 2398667 Patent No. GB 2383375B Community Trd Mark No. 002906428 Linea-Rondo CFX is a UK Registered Design Certificate No: R21=2106349 SS2=2106350

R Hamilton & Co Ltd, Unit 10 Carrick Business Centre,  
4-5 Bonville Road, Brislington, Bristol, BS4 5NZ

**T:** +44 (0)1747 860088

**E:** [info@hamilton-litestat.com](mailto:info@hamilton-litestat.com) | **W:** [www.hamilton-litestat.com](http://www.hamilton-litestat.com)

(WEB)

All accessories are manufactured under an accredited BS EN ISO 9001:2015 Quality Management System. It is the policy of the company to improve products as part of our development programme. Therefore, we reserve the right to alter designs and dimensions without prior notice. Illustrations and diagrams are reproduced within the limitations of reproduction and printing process and are not binding. Due to manufacturing processes we cannot guarantee an exact colour match and shadings of certain finishes. This datasheet was generated on 05/05/2024 E&OE