

Code: LRX1X40BK-BS  
Linea-Rondo CFX | LINEA-RONDO CFX RANGE | Resistive Leading Edge Push On/Off Rotary  
2 Way Switching Dimmers

Product Image

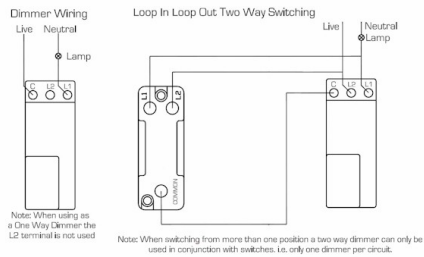

Wiring



Dimensions

Insert Type	1 gang 400W Resistive Leading Edge Push On/Off Rotary 2 Way Switching Dimmer
Insert Colour	Black Nickel
EAN13 Barcode	5017504379414
Commodity Code	85365015
Luckins TSI	391671850
ETIM Class	EC000025
Dimensions(Nominal)	Single: Height = 91.5mm Width = 91.5mm Depth = 4.0mm
Fixing Hole Centres	Box Fixing = 60.3mm Grid Fixing = CFX Clips
Minimum Wall Box Depth	35mm
Switched Poles	Single
Current Rating	1.66 Amp
Voltage	230V AC
Maximum Load	400W resistive Max Load
Mains Frequency	50Hz
IP Rating	IP2XD
Contact Gap Minimum	N/A
Terminal Capacity 1	2x1mm <sup>2</sup>
Terminal Capacity 2	2x1.5mm <sup>2</sup>
Earth Terminal Capacity 1	5x1mm <sup>2</sup>
Earth Terminal Capacity 2	4 x 1.5mm <sup>2</sup>
Earth Terminal Capacity 3	3 x 2.5mm <sup>2</sup>
Earth Terminal Capacity 4	1 x 4mm <sup>2</sup> Multi-strand
Earth Terminal Capacity 5	1 x 6mm <sup>2</sup>
Product Class 1	Face plate must be earthed
Ambient Operating Temperature	-5° to +40°C
Recommended Location	Internal Use Only
Maximum Installation Altitude	2000m
Standard/Approval	BS EN 60669-2-1

**Code:** LRX1X40BK-BS

## Linea-Rondo CFX | LINEA-RONDO CFX RANGE | Resistive Leading Edge Push On/Off Rotary 2 Way Switching Dimmers

**Hamilton<sup>®</sup>**

LINEA RONDO CFX

1X40

Resistive Leading Edge Push On-Off Rotary  
2 Way Switching Dimmer

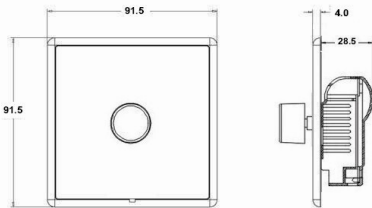

### Additional Notes

Tungsten filament GU10 lamps must be branded with a fuse base. When using mains voltage halogen lamps- dimmers should be de-rated by 25%. When dimming LED lamps de-rated by 75% - please contact our Technical for compatibility.

### Patents And Trade Marks

Linea is a Registered Trade Mark No 2398665 CFX is a Registered Trade Mark No 2398667 Patent No. GB 2383375B Community Trd Mark No. 002906428 Linea-Rondo CFX is a UK Registered Design Certificate No: R21=2106349 SS2=2106350

R Hamilton & Co Ltd, Unit 10 Carrick Business Centre,  
4-5 Bonville Road, Brislington, Bristol, BS4 5NZ

**T:** +44 (0)1747 860088

**E:** [info@hamilton-litestat.com](mailto:info@hamilton-litestat.com) | **W:** [www.hamilton-litestat.com](http://www.hamilton-litestat.com)

(WEB)

All accessories are manufactured under an accredited BS EN ISO 9001:2015 Quality Management System. It is the policy of the company to improve products as part of our development programme. Therefore, we reserve the right to alter designs and dimensions without prior notice. Illustrations and diagrams are reproduced within the limitations of reproduction and printing process and are not binding. Due to manufacturing processes we cannot guarantee an exact colour match and shadings of certain finishes. This datasheet was generated on 29/04/2024 E&OE